

## STONEBRAKER - R2545A3F-0

Total Area: **2545 Sq. Ft.**  
Garage Area: **704 Sq. Ft.**  
Garage Size: **3**  
Stories: **1**  
Bedrooms : **2**  
Full Baths : **2**  
Half Baths :  
Width : **80`-0"**  
Depth : **65`-0"**  
Height : **20`-0"**  
Foundation : **Crawl Space**



# STONEBRAKER - R2545A3F-0

## MAIN FLOOR

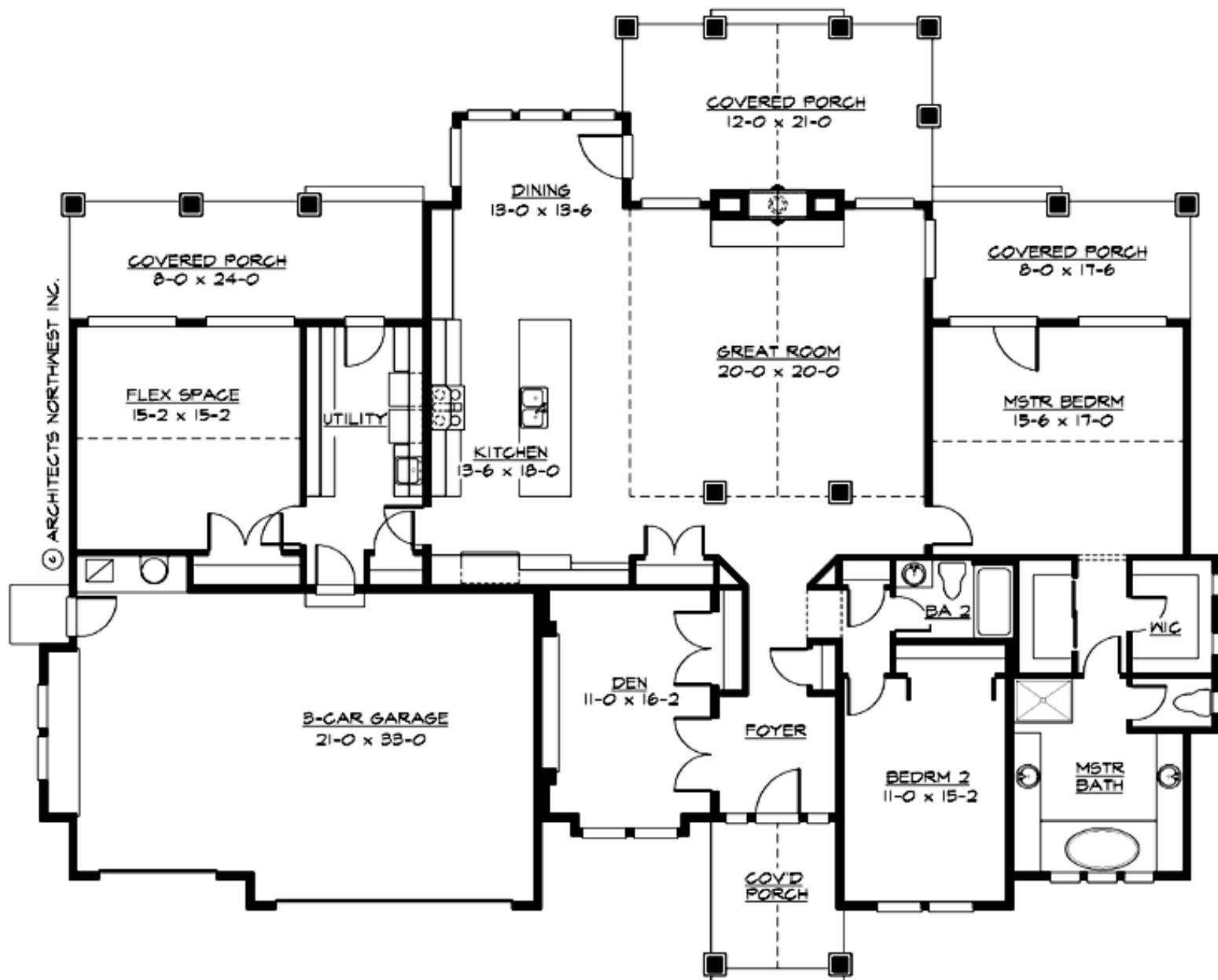

# STONEBRAKER - R2545A3F-0

## PLAN DETAILS

### Area Summary

Total Area:	2545 Sq. Ft.
Main Floor:	2545 Sq. Ft.
Garage Floor:	704 Sq. Ft.

### General Information

Stories:	1
Width:	80`-0"
Depth:	65`-0"
Height:	20`-0"

### Architectural Style

Craftsman  
Northwest  
Shingle

### Number of Rooms

Bedrooms:	2
Full Baths:	2

### Garage

Garage Size:	3
Garage Door Location:	Front

### Roof Pitches

Primary:	6:12
----------	------

### Wall Heights

Main:	9-0"
-------	------

### Foundation Type

Crawl Space

### Roof Framing

Trusses

### Floor Load

Live (lbs):	40 PSF
Dead (lbs):	10 PSF

### Roof Load

Live (lbs):	25 PSF
Dead (lbs):	15 PSF
Wind:	85 MPH

### Design Features

- Bonus Space @ Main Floor
- Den/Office
- Rear Porch
- Great Room
- Laundry Room @ Main Floor
- Master Bedroom @ Main Floor Rear
- Craftsman House Plans
- Northwest Floor Plans
- Shingle House Plans
- Small House Plans
- Wide Lot House Plans