

# MANSVILLE GROVE - R5340A4FAT-1

Total Area: **5428 Sq. Ft.**  
Garage Area: **1807 Sq. Ft.**  
Garage Size: **4**  
Stories: **2**  
Bedrooms : **3**  
Full Baths : **4**  
Half Baths : **1**  
Width : **130`-0"**  
Depth : **109`-6"**  
Height : **27`-6"**  
Foundation : **Crawl Space**



# MANSVILLE GROVE - R5340A4FAT-1

## MAIN FLOOR



# MANSVILLE GROVE - R5340A4FAT-1

## UPPER FLOOR

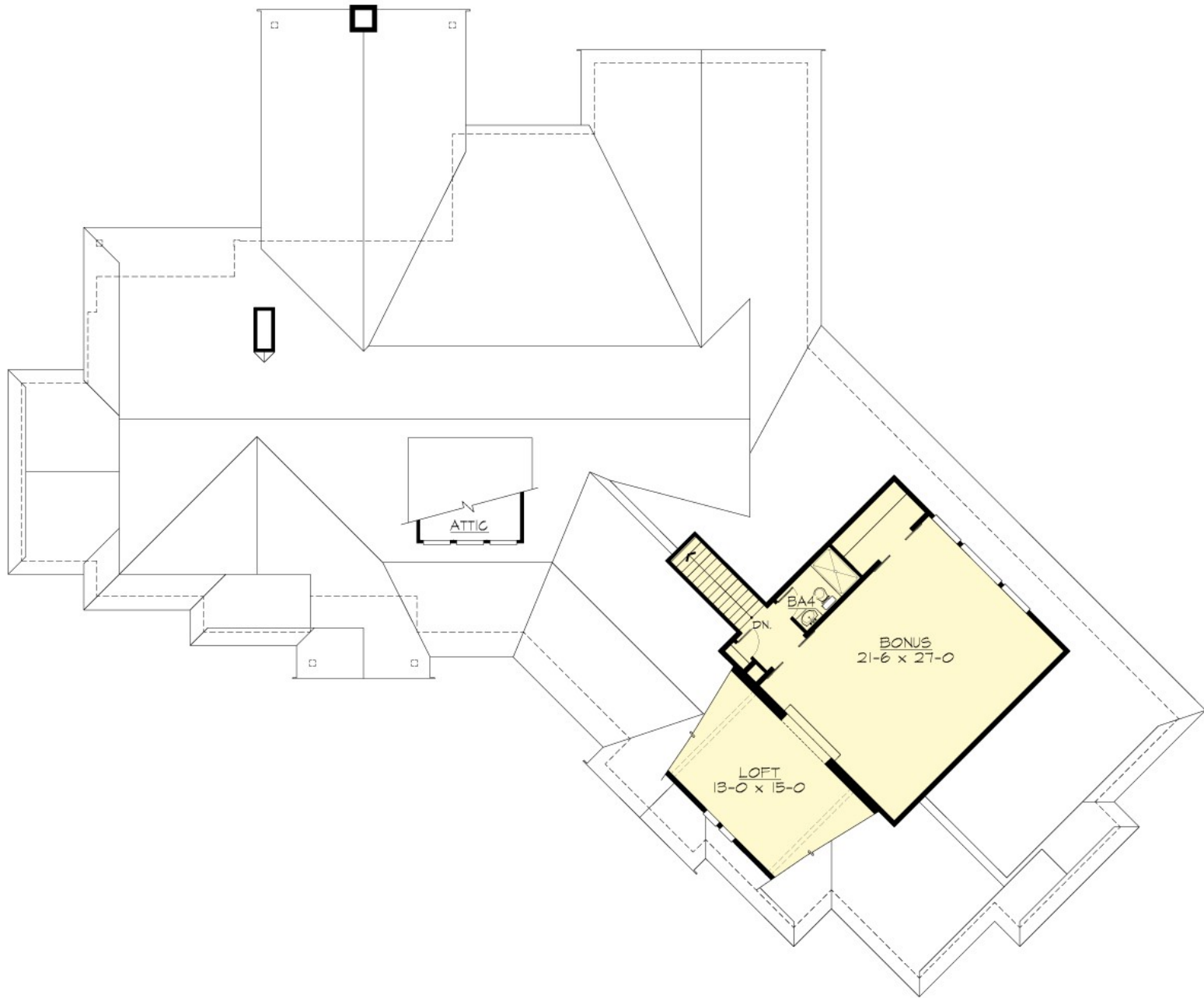

# MANSVILLE GROVE - R5340A4FAT-1

## PLAN DETAILS

### Area Summary

Total Area:	5428 Sq. Ft.
Main Floor:	4423 Sq. Ft.
Upper Floor:	1005 Sq. Ft.
Garage Floor:	1807 Sq. Ft.

### General Information

Stories:	2
Width:	130`-0"
Depth:	109`-6"
Height:	27`-6"

### Architectural Style

Craftsman  
Shingle  
Traditional

### Number of Rooms

Bedrooms:	3
Full Baths:	4
Half Baths:	1

### Garage

Garage Size:	4
Garage Door Location:	Front
Garage Type:	Angled

### Roof Pitches

Primary:	10:12
Secondary:	5:12

### Wall Heights

Main:	10-0"
Upper:	9-0"

### Foundation Type

Crawl Space

### Roof Framing

Combination

### Floor Load

Live (lbs):	40 PSF
Dead (lbs):	10 PSF

### Roof Load

Live (lbs):	25 PSF
Dead (lbs):	15 PSF
Wind:	85 MPH

### Design Features

- Bonus Space @ Main & Upper Floor
- Den/Office
- Rear Porch
- Great Room
- Laundry Room @ Main Floor
- Master Bedroom @ Main Floor Rear
- Craftsman House Plans
- Shingle House Plans
- Traditional House Plans
- View Lot (Rear) Plans
- Wide Lot House Plans