

MALDEN MEADOWS - M1852A2F-0

Total Area: **1852 Sq. Ft.**
Garage Area: **418 Sq. Ft.**
Garage Size: **2**
Stories: **2**
Bedrooms : **4**
Full Baths : **2**
Half Baths : **1**
Width : **30'-0"**
Depth : **51'-0"**
Height : **22'-0"**
Foundation : **Crawl Space**



MALDEN MEADOWS - M1852A2F-0

MAIN FLOOR

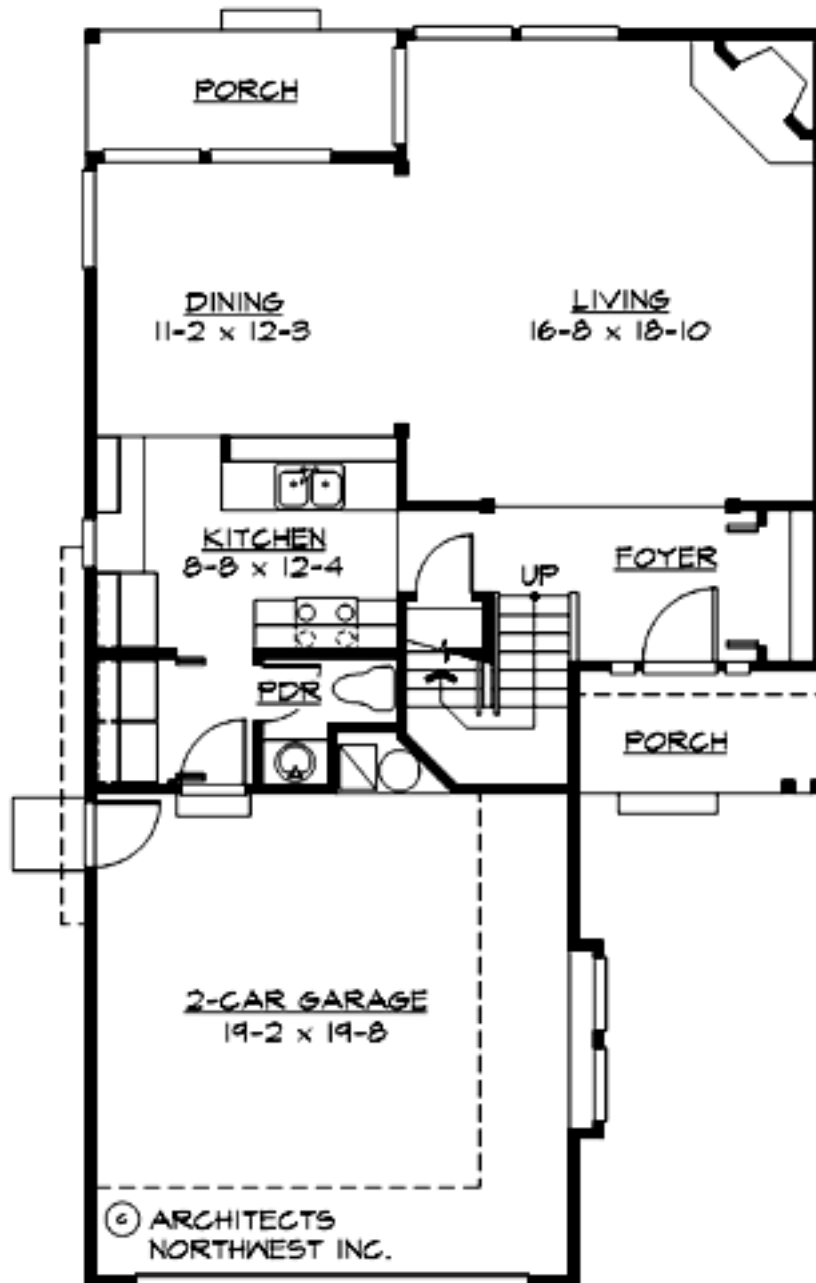

MALDEN MEADOWS - M1852A2F-0

UPPER FLOOR

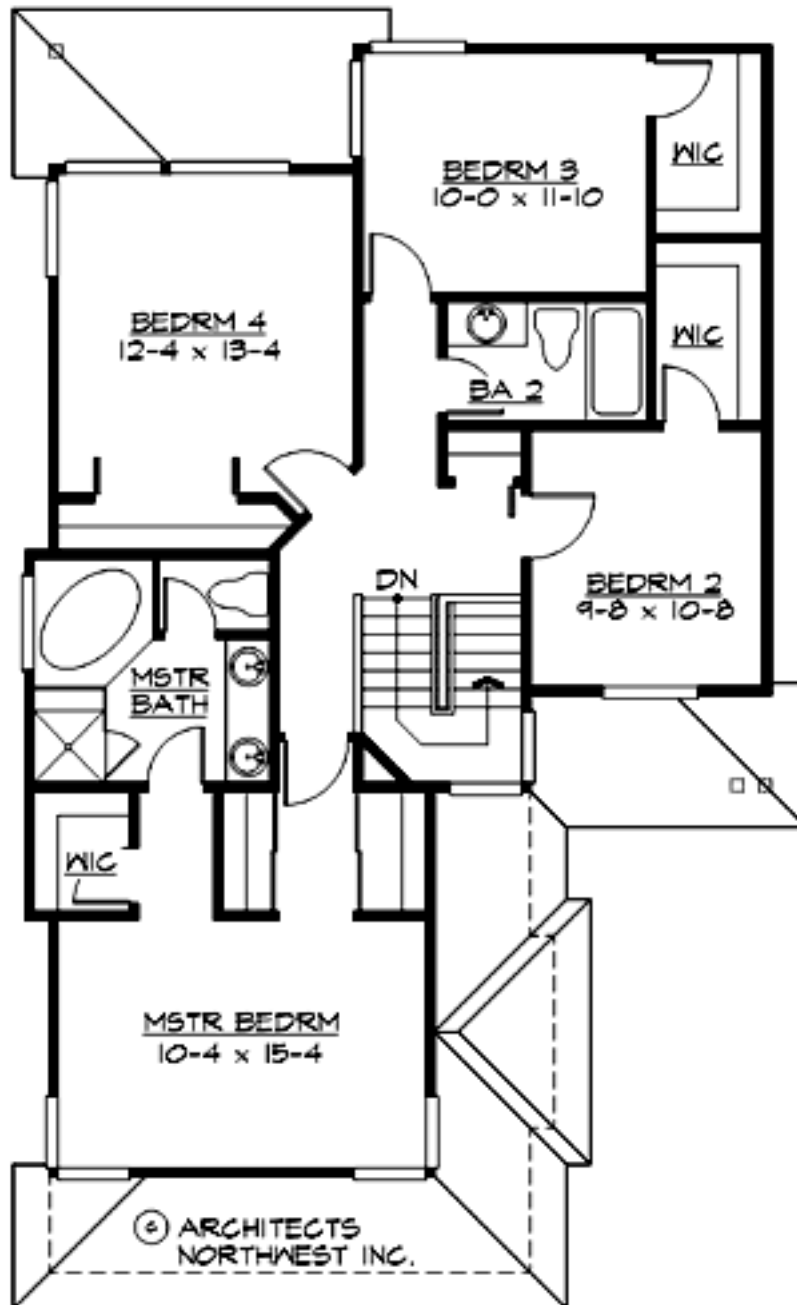

MALDEN MEADOWS - M1852A2F-0

PLAN DETAILS

Area Summary

Total Area:	1852 Sq. Ft.
Main Floor:	807 Sq. Ft.
Upper Floor:	1045 Sq. Ft.
Garage Floor:	418 Sq. Ft.

General Information

Stories:	2
Width:	30`-0"
Depth:	51`-0"
Height:	22`-0"

Architectural Style

Craftsman
Farmhouse
Northwest

Number of Rooms

Bedrooms:	4
Full Baths:	2
Half Baths:	1

Garage

Garage Size:	2
Garage Door Location:	Front

Roof Pitches

Primary:	5:12
----------	------

Wall Heights

Main:	8-0"
Upper:	8-0"

Foundation Type

Crawl Space

Roof Framing

Trusses

Floor Load

Live (lbs):	40 PSF
Dead (lbs):	10 PSF

Roof Load

Live (lbs):	25 PSF
Dead (lbs):	15 PSF
Wind:	85 MPH

Design Features

- Front and Rear Porch
- Great Room
- Laundry Room @ Main Floor
- Master Bedroom @ Upper Floor Front
- Craftsman House Plans
- Farmhouse Home Plans
- Northwest Floor Plans
- Narrow Lot House Plans
- Small House Plans