

GOLDENDALE SHOP - A2335A6FT-0

Total Area: **0 Sq. Ft.**
Garage Area: **2336 Sq. Ft.**
Garage Size: **5+**
Stories: **1**
Bedrooms :
Full Baths :
Half Baths :
Width : **56`-0"**
Depth : **48`-0"**
Height : **27`-0"**
Foundation : **Slab**



GOLDENDALE SHOP - A2335A6FT-0

MAIN FLOOR

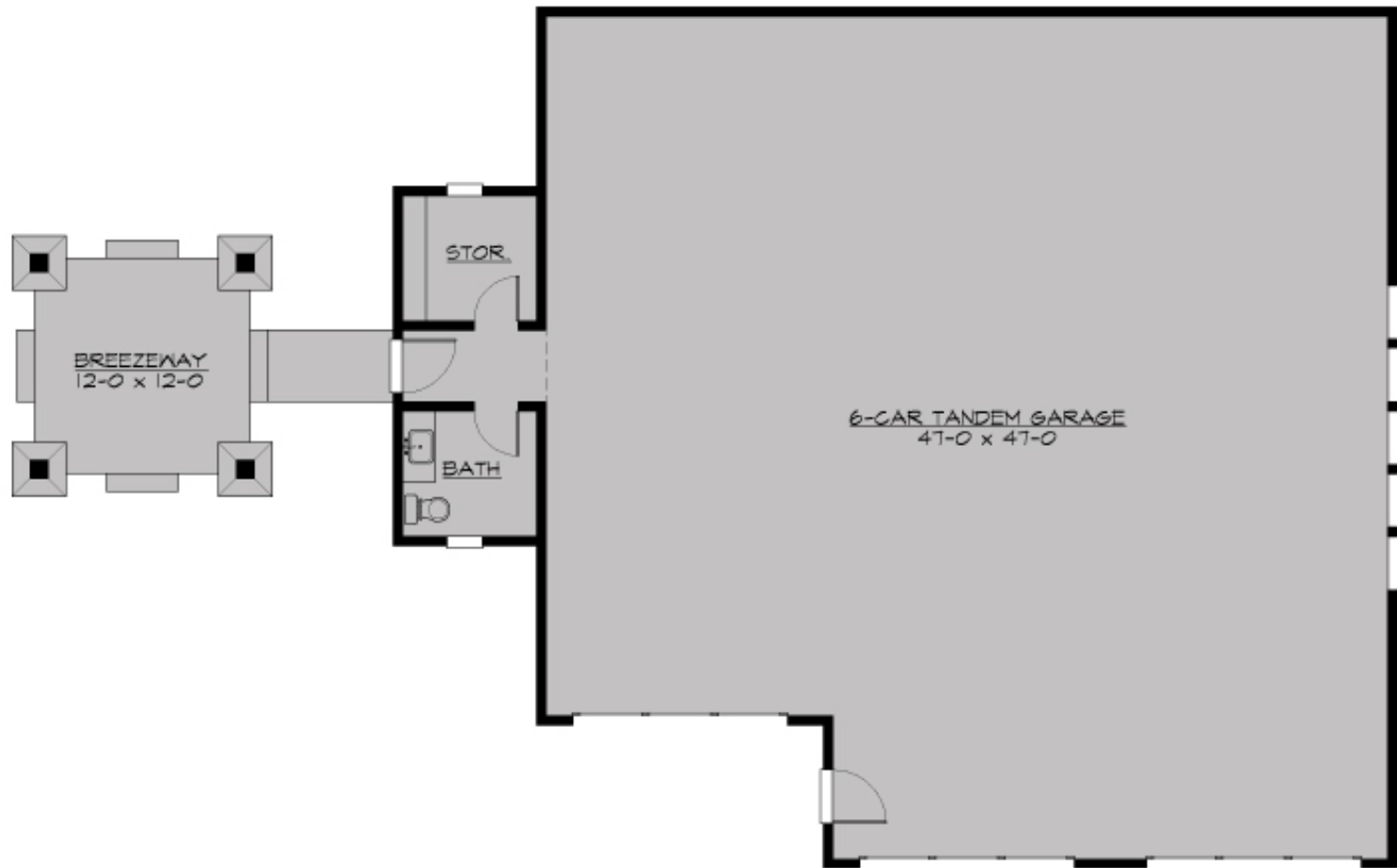

GOLDENDALE SHOP - A2335A6FT-0

PLAN DETAILS

Area Summary

Garage Floor: 2336 Sq. Ft.

Wall Heights

Main: 16'-0"

General Information

Stories: 1
Width: 56'-0"
Depth: 48'-0"
Height: 27'-0"

Foundation Type

Slab On Grade

Roof Framing

Trusses

Architectural Style

Country
Craftsman
Farmhouse

Floor Load

Live (lbs): 40 PSF
Dead (lbs): 10 PSF

Number of Rooms

Roof Load

Live (lbs): 25 PSF
Dead (lbs): 15 PSF
Wind: 85 MPH

Garage

Garage Size: 5+
Garage Door Location: Front
Garage Type: Tandem

Design Features

- Great Room
- Country House Plans
- Craftsman House Plans
- Farmhouse Home Plans
- Affordable Home Designs
- Wide Lot House Plans

Roof Pitches

Primary: 8:12
Secondary: 4:12