

GLACIER PEAK - M1450A0-0

Total Area: **1450 Sq. Ft.**
Garage Area: **0 Sq. Ft.**
Garage Size: **No Garage**
Stories: **2**
Bedrooms : **3**
Full Baths : **2**
Half Baths :
Width : **32`-0"**
Depth : **37`-0"**
Height : **23`-6"**
Foundation : **Crawl Space**



GLACIER PEAK - M1450A0-0

MAIN FLOOR

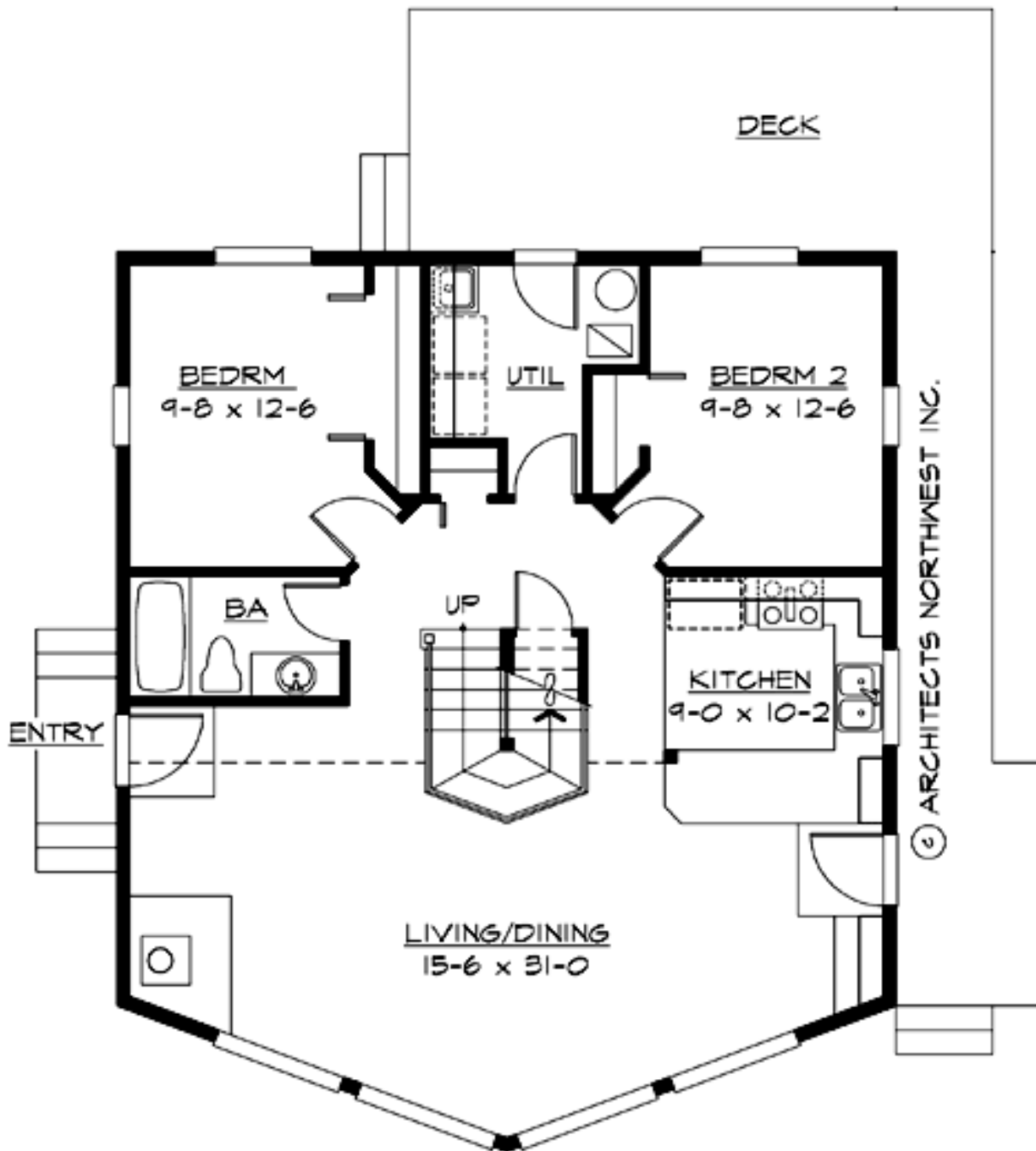

GLACIER PEAK - M1450A0-0

UPPER FLOOR

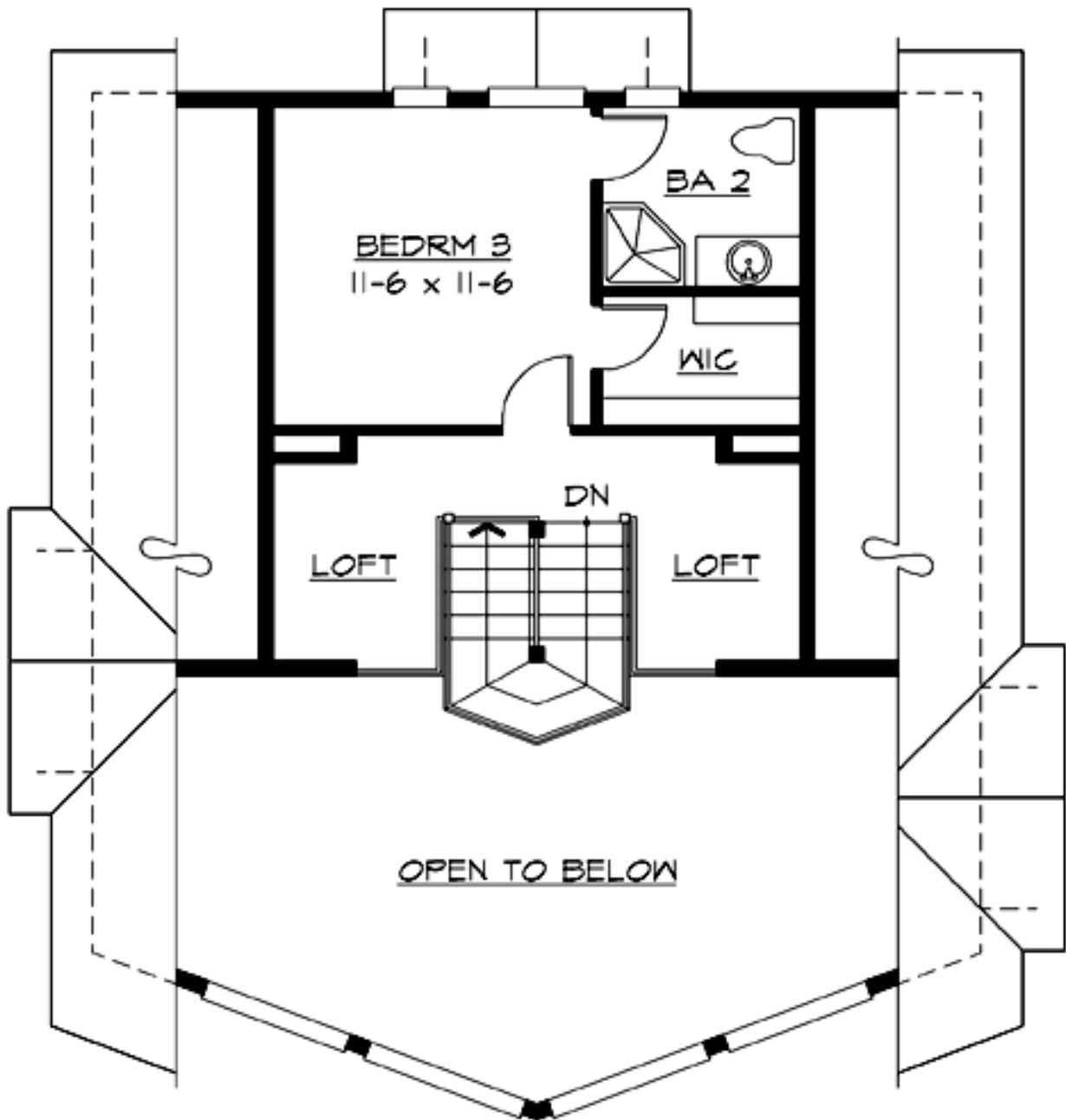

© ARCHITECTS NORTHWEST INC.

GLACIER PEAK - M1450A0-0

PLAN DETAILS

Area Summary

| | |
|--------------|---------------------|
| Total Area: | 1450 Sq. Ft. |
| Main Floor: | 1088 Sq. Ft. |
| Upper Floor: | 362 Sq. Ft. |

General Information

| | |
|----------|---------------|
| Stories: | 2 |
| Width: | 32`-0" |
| Depth: | 37`-0" |
| Height: | 23`-6" |

Architectural Style

Alpine
Cottage
Mountain

Number of Rooms

| | |
|-------------|----------|
| Bedrooms: | 3 |
| Full Baths: | 2 |

Garage

Garage Size: **No Garage**

Roof Pitches

Primary: **9:12**

Wall Heights

| | |
|--------|-------------|
| Main: | 8-0" |
| Upper: | 8-0" |

Foundation Type

Crawl Space

Roof Framing

Stick

Floor Load

| | |
|-------------|---------------|
| Live (lbs): | 40 PSF |
| Dead (lbs): | 10 PSF |

Roof Load

| | |
|-------------|---------------|
| Live (lbs): | 25 PSF |
| Dead (lbs): | 15 PSF |
| Wind: | 85 MPH |

Design Features

- Great Room
- Laundry Room @ Main Floor
- Master Bedroom @ Upper Floor Rear
- Alpine House Designs
- Cottage House Plans
- Mountain House Plans
- Narrow Lot House Plans
- Vacation House Plans