

ELLENSBURG - R2195A3FA-0DB

Total Area: **3634 Sq. Ft.**
Garage Area: **1023 Sq. Ft.**
Garage Size: **3**
Stories: **2**
Bedrooms : **2**
Full Baths : **3**
Half Baths : **1**
Width : **110`-0"**
Depth : **61`-0"**
Height : **21`-6"**
Foundation : **Basement**



ELLENSBURG - R2195A3FA-0DB

MAIN FLOOR

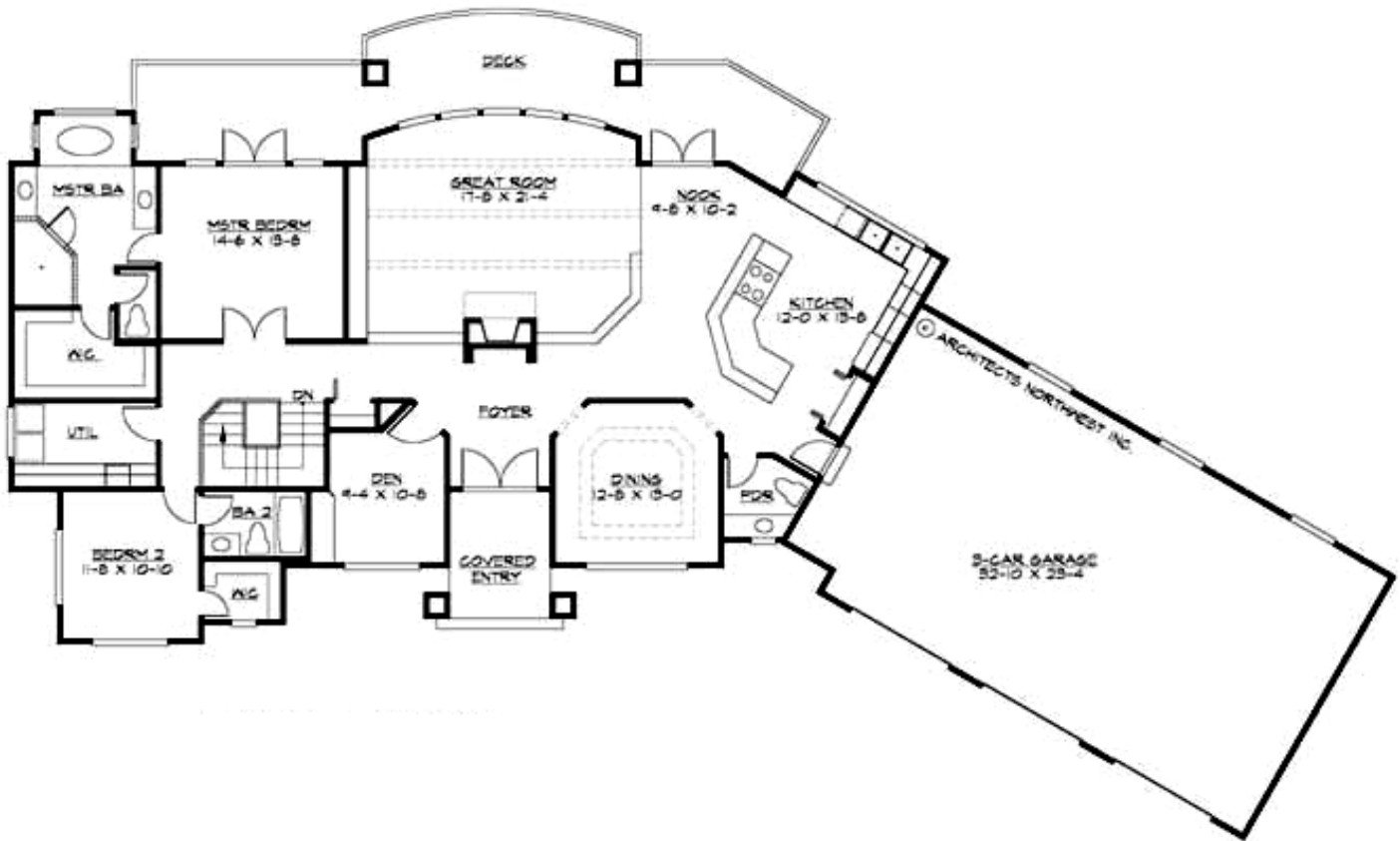

ELLENSBURG - R2195A3FA-0DB

LOWER FLOOR

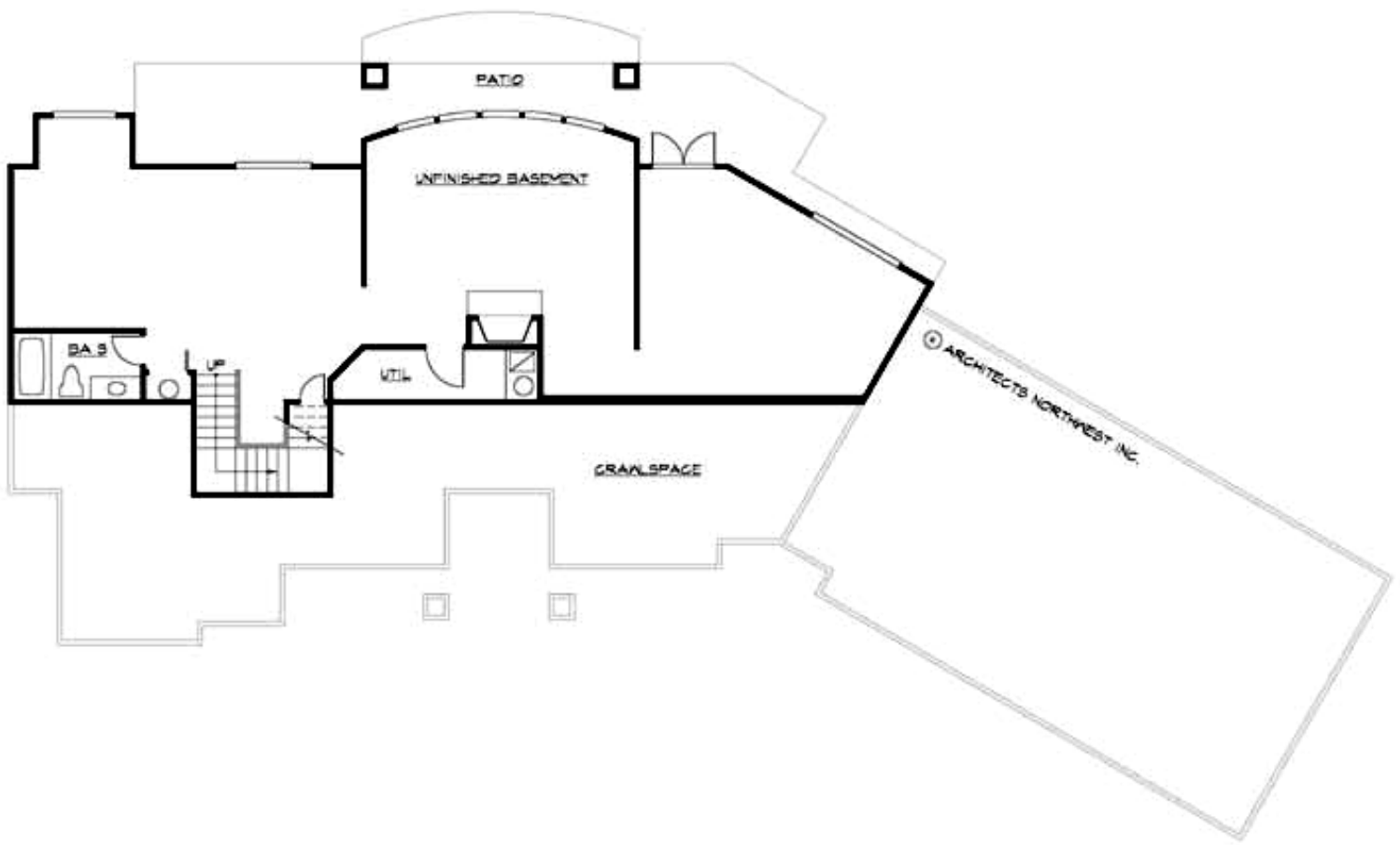

ELLENSBURG - R2195A3FA-0DB

PLAN DETAILS

Area Summary

| | |
|---------------|---------------------|
| Total Area: | 3634 Sq. Ft. |
| Main Floor: | 2195 Sq. Ft. |
| Lower Floor: | 1439 Sq. Ft. |
| Garage Floor: | 1023 Sq. Ft. |

General Information

| | |
|----------|----------------|
| Stories: | 2 |
| Width: | 110`-0" |
| Depth: | 61`-0" |
| Height: | 21`-6" |

Architectural Style

Craftsman
Lodge
Northwest

Number of Rooms

| | |
|-------------|----------|
| Bedrooms: | 2 |
| Full Baths: | 3 |
| Half Baths: | 1 |

Garage

| | |
|-----------------------|---------------|
| Garage Size: | 3 |
| Garage Door Location: | Front |
| Garage Type: | Angled |

Roof Pitches

| | |
|------------|--------------|
| Primary: | 9:12 |
| Secondary: | 12:12 |

Wall Heights

| | |
|--------|--------------|
| Main: | 9-0" |
| Lower: | 10-0" |

Foundation Type

Daylight Basement

Roof Framing

Trusses

Floor Load

| | |
|-------------|---------------|
| Live (lbs): | 40 PSF |
| Dead (lbs): | 10 PSF |

Roof Load

| | |
|-------------|---------------|
| Live (lbs): | 25 PSF |
| Dead (lbs): | 15 PSF |
| Wind: | 85 MPH |

Design Features

- Best Selling Plans
- Bonus Space @ & Lower Floor
- Den/Office
- Rear Porch
- Great Room
- Laundry Room @ Main Floor
- Master Bedroom @ Main Floor Rear
- Craftsman House Plans
- Lodge House Plans
- Northwest Floor Plans
- Wide Lot House Plans