

BRYCEN - R1930A3F-0

Total Area: **1930 Sq. Ft.**
Garage Area: **780 Sq. Ft.**
Garage Size: **3**
Stories: **1**
Bedrooms : **3**
Full Baths : **2**
Half Baths :
Width : **66`-0"**
Depth : **60`-0"**
Height : **21`-6"**
Foundation : **Crawl Space**



BRYCEN - R1930A3F-0

MAIN FLOOR

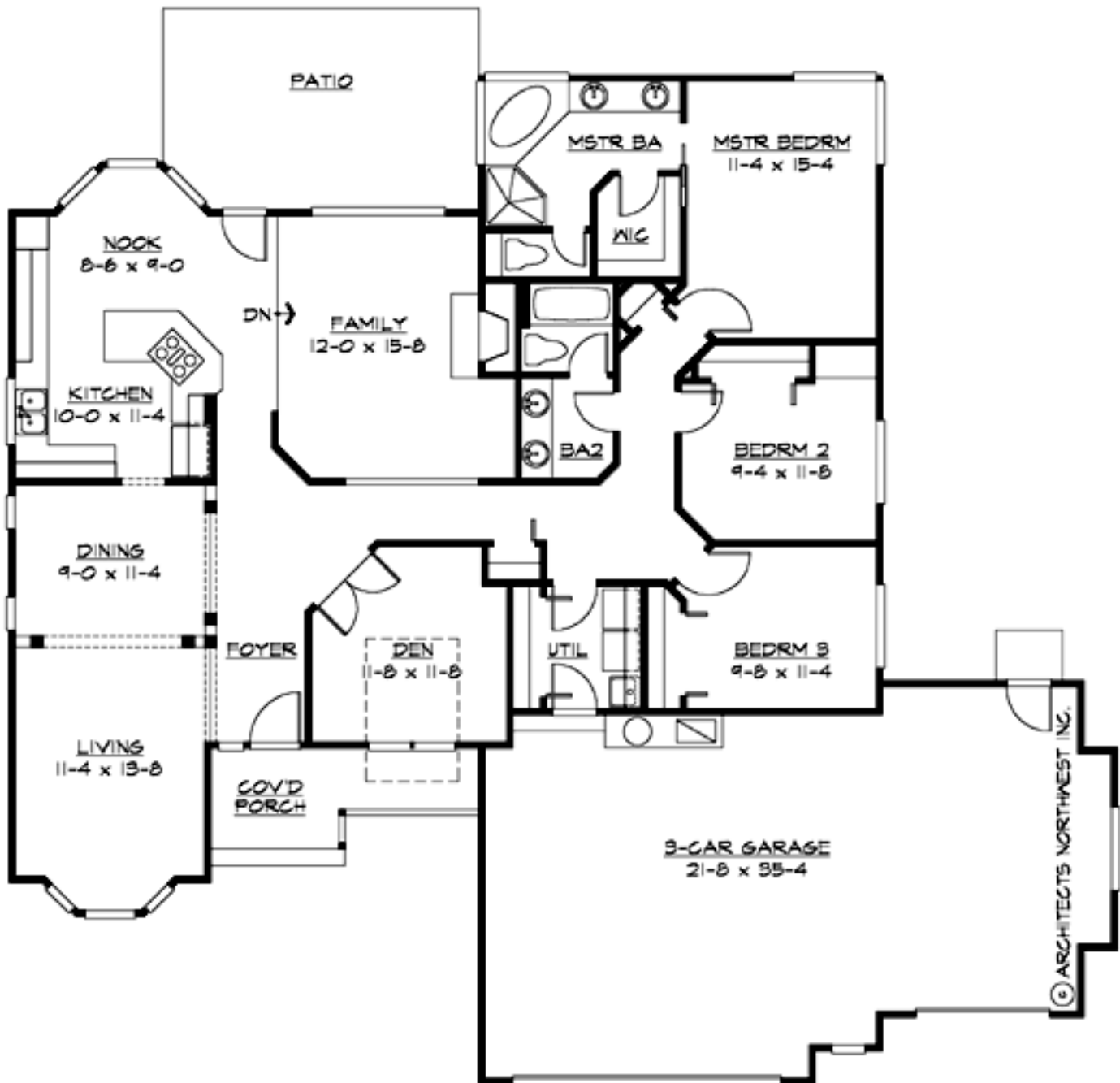

BRYCEN - R1930A3F-0

PLAN DETAILS

Area Summary

Total Area:	1930 Sq. Ft.
Main Floor:	1930 Sq. Ft.
Garage Floor:	780 Sq. Ft.

General Information

Stories:	1
Width:	66`-0"
Depth:	60`-0"
Height:	21`-6"

Architectural Style

Craftsman
Farmhouse
Ranch

Number of Rooms

Bedrooms:	3
Full Baths:	2

Garage

Garage Size:	3
Garage Door Location:	Front

Roof Pitches

Primary:	8:12
----------	------

Wall Heights

Main:	9-0"
-------	------

Foundation Type

Crawl Space

Roof Framing

Trusses

Floor Load

Live (lbs):	40 PSF
Dead (lbs):	10 PSF

Roof Load

Live (lbs):	25 PSF
Dead (lbs):	15 PSF
Wind:	85 MPH

Design Features

- Den/Office
- Front Porch
- Great Room
- Laundry Room @ Main Floor
- Master Bedroom @ Main Floor Rear
- Craftsman House Plans
- Farmhouse Home Plans
- Ranch House Plans
- Affordable Home Designs
- Small House Plans